



CONSULTING ARBORIST, INC.

**DRC**  
Page 1 of 19

PZ23-12000009

01/02/2025

## Arboriculture Tree Report Pompano Indoor Tennis Center

**Name:** Tonning and Associates, INC.

**Attn.:** Wayne Tanning

**Address:** 4855 NW 92 Terrace

**Date:** October 4<sup>th</sup>, 2024

**Phone:** 561.414.8269

**Email:** wtonning@tonningandassociates.com

**Prepared by:** Trea Jones  
International Society of Arboriculture Certified Arborist

### Certification of Performance

I, Trea Jones, certify to the best of my knowledge, and abilities:

That I have personally inspected the tree(s) and or the property referred to in this report.

That it is my professional opinion, that the following report is true, and the conclusions and results stated are correct based on the information received about the property evaluated and the evaluation methods followed.

**DRC**

PZ23-12000009

03/05/2025

That the reported analyses, opinions, and conclusions are only limited by the reported assumptions, methods and limiting conditions and my personal, unbiased professional analyses, opinions and conclusions.

That Sutton Consulting Arborist, Inc. acts as an independent tree, and landscape consultant. This firm has no prospective or current interest in the property evaluated or interest/bias with respect to the parties involved.

That this Report, or parts of this Report, have not been revealed to any party other than the Client named and will not be revealed to any other party unless authorized to do so by Client named or by due process of law or by legally required public testimony by this firm of these results.

This report is written in good faith and all rights are reserved by Sutton Consulting Arborist, Inc. It is for use by the client named only.

Trea Jones  
Trea Jones/Sutton Consulting Arborist  
ISA Certified Arborist #FL-9929A

# Report

## I. Introduction

The property is an empty lot. My assignment is to evaluate all trees and palms on site for health, condition, and appraisal method 14:40 compliant with pompano codes.

## II. Property Involved

The property involved is known as Pompano Indoor Tennis Center, FL. I arrived on site 10-05-2024. The trees/palms are located throughout the property.

## III. Data Collection

The property/trees were evaluated by site visit to determine environmental conditions, species, size (DBH and height) condition as a percentage and pictures.

## IV. Limiting Conditions

This “Arboriculture Report” includes only the listed trees, landscape conditions in the immediate area where the tree is located, and conditions caused by or attributable to the trees on this property. We did not evaluate and make no evaluation or conclusions regarding any other part of the landscape or other items of this property.

**DRC**

### Limits of the Assignment

PZ23-12000009

1. This report is not intended as and does not represent legal advice and should not be relied upon to take the place of such advice.
2. This report is limited to documenting the condition of the tree on the dates given. Care has been taken to obtain all information from reliable sources. All data has been verified insofar as possible; however, the consultant can neither guarantee nor be responsible for the accuracy of information provided by others.
3. Loss or alteration of any part of this report invalidates the entire report.
4. Sketches and photographs used in this report are intended as visual aids only and are not necessarily to scale.

## V. Discussion

A landscape is not a forest, woods, or other wild habitat. It is intended to be a planned and controlled environment. Trees can cause considerable damage to structures when not planted in the right locations based on species and mature size. Trees should be planted with adequate green space for mature tree size both above and below ground in-order to prevent conflicts with structures above and below ground. The appearance and value of a landscape suffer, and the property devaluates due to poor tree selection and placement.



Poorly planned landscapes also give rise to possible property damage, bodily injury and other negative circumstances and unnecessary expenses

Professionally designed and professionally maintained landscape, plants, shrubs, and trees traditionally stabilize and/or increase property values.

Trees growing in groups depend on each member of the group for stability of their root systems, wind breaks and shade. They work as one unit and appear as one from an aerial view. The loss of one or more from the group can and does have a detrimental effect on health, stability as well as aesthetics.

Most tree roots grow out horizontally from the tree in the top 6-12 inches of soil. A mature tree's roots can spread 2-3 times the diameter of the tree's crown or canopy.

### **Critical Root Zone (CRZ)**

For existing trees, there is a minimum amount of area, above (for the trunk and crown) and below ground (for soil health and the root system vitality) that is required to protect trees and preserve tree health. This area is identified as the Critical Root Zone (CRZ) and is generally agreed to be equivalent to the soil area below ground and the space above ground defined by the tree's dripline, or the greatest extent of the branches. Significant risk of catastrophic failure exists if structural roots within this given radius are destroyed or severely damaged. Limits of disruption are based upon tree diameter (DBH) at 4.5 feet above the ground. We define the Critical Root Zone for all trees as the circular area above and below ground with a radius equivalent to the greater of 6 feet or 1.0 feet for every inch in trunk diameter at 4.5 feet above the ground. For example, a tree with a trunk diameter (DBH) of 10 inches has a DRC of 10 feet (10 inches x 1.0) around the tree. While the radius of the CRZ is 10 feet, the diameter of the entire CRZ is 20 feet.

PZ23-12000009

03/05/2025

Generally, the full Perimeter (PCRZ) is considered the optimum amount of root protection for a tree. (The ICRZ is identified as the inner half of the CRZ radius). As root impact occurs within the PCRZ, greater post care will be required for the tree to remain alive and stable. The absolute maximum disturbance allowed must still leave the ICRZ undisturbed if the tree is to have any chance of survival.

The CRZ (Critical Root Zone) is calculated at 1" of root for each inch of trunk diameter at or near breast height (dbh). This gives the radius of the CRZ.

Example:

Tree Diameter		CRZ		Tree Diameter		CRZ	
2" diameter	2' radius			16" diameter	16' radius		
4" diameter	4' radius			20" diameter	20' radius		
6" diameter	6' radius			24" diameter	24' radius		
10" diameter	10' radius			30" diameter	30' radius		
12" diameter	12' radius			40" diameter	40' radius		

The CRZ of a tree, also called the "tree protection zone", is often defined as an imaginary circle on the ground that corresponds with the "dripline" of the tree. However, the dripline is very irregular and misleading, so the trunk diameter is referred to.

This is a generally accepted method for measuring CRZ, root systems do vary in depth and spread based on size of tree, soil quality, water table, species, and other related factors such as root obstructions.

PZ23-12000009  
01/02/2025

## VI. Conclusions and Recommendations

Please see survey with tree locations, excel spreadsheet and pictures below. All trees accessible have been tagged with numbers that correspond with report and survey.

Total tree appraisal: \$116,678.68

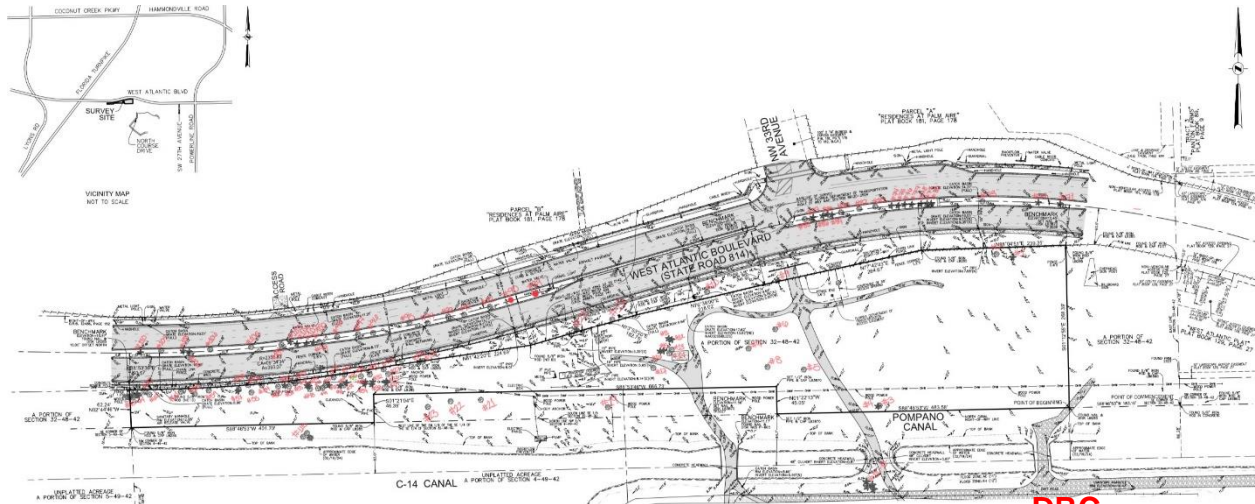

DRC

PZ23-12000009  
03/05/2025

Tree #	Common name	Botanical name	DBH	Height CT	Height OA	Canopy square ft	Condition	Price per in / ft	Value before Diminution	Value	Notes
1	Sabal palm	<i>Sabal palmetto</i>		17		16x16	70%	\$32.99	\$560.83	\$392.58	Trunk heavy with vine
2	Strangler fig	<i>Ficus aurea</i>	15		35	30x30	50%	\$314.58	\$4,718.70	\$2,359.35	Multi stemmed
3	Indian rose wood	<i>Dalbergia sissoo</i>	25.5			40x20	15%	\$172.17	\$4,390.34	\$658.55	Major tip decline major decay, dead wood, decay in first-order branches
4	Sabal palm	<i>Sabal palmetto</i>		6		14x24	60%	\$32.99	\$197.94	\$118.76	Sub-canopy to rosewood tree
5	Black olive	<i>Bucida buceras</i>	18			60x60	45%	\$358.33	\$6,449.94	\$2,902.47	Decay in first and second-order branches, previous trunk damage
6	Java plum	<i>Syzygium cumini</i>	46.5			55x40	40%	\$0.00	\$0.00	\$0.00	Previous hatrack pruning, multi co-dom, poor structure, decay in first and second-order branches
7	Black olive	<i>Bucida buceras</i>	23			55x40	40%	\$358.33	\$8,241.59	\$3,296.64	Co-dom with inclusion, co-canopy, decay in first and second-order branches, sparse foliage
8	Black olive	<i>Bucida buceras</i>	22			60x50	50%	\$358.33	\$7,883.26	\$3,941.63	Decay in first order, previous storm damage, poor structure
9	Sabal palm	<i>Sabal palmetto</i>		9		12x12	70%	\$32.99	\$296.91	\$207.84	
10	Java plum	<i>Syzygium cumini</i>	35		17	20x20	60%	\$0.00	\$0.00	\$0.00	Multi-stemmed, invasive species
11	Sabal palm	<i>Sabal palmetto</i>		25		16x16	70%	\$32.99	\$824.75	\$577.33	
12	Sabal palm	<i>Sabal palmetto</i>		4		16x16	70%	\$32.99	\$131.96	\$92.37	
13	Live oak	<i>Quercus virginiana</i>	22		20	40x30	70%	\$354.17	\$7,791.74	\$5,454.22	Cluster 7 trunks 22 DBH with all trunks

PZ23-12000009

01/02/2025

Tree #	Common name	Botanical name	DBH	Height CT	Height OA	Canopy square ft	Condition	Price per in / ft	Value before Diminution	Value	Notes
14	Acacia	<i>Acacia auriculiformis</i>	8.5		25	26x22	50%	\$0.00	\$0.00	\$0.00	Co-canopy, invasive species
15	Christmas palm DBL	<i>Adonidia merrillii</i>		13		12x12	70%	\$91.67	\$2,383.42	\$1,668.40	Two trunks
16	Christmas palm	<i>Adonidia merrillii</i>		13		12x12	70%	\$91.67	\$1,191.71	\$834.20	
17	Live oak	<i>Quercus virginiana</i>	10.5		20	30x30	50%	\$354.17	\$3,718.79	\$1,859.39	Major sucker growth on trunk, co-dom, poor structure
18	Live oak	<i>Quercus virginiana</i>	3.5		15	14x14	60%	\$354.17	\$1,239.60	\$743.76	
19	Strangler fig	<i>Ficus aurea</i>	4.5			16x12	50%	\$314.58	\$1,415.61	\$707.81	Co-canopy
20	Sabal palm	<i>Sabal palmetto</i>		17		16x16	70%	\$32.99	\$560.83	\$392.58	
21	Schefflera	<i>Schefflera actinophylla</i>	36		25	40x40	50%	\$0.00	\$0.00	\$0.00	Multi-stemmed, decay in first and second-order branches, invasive species
22	Acacia	<i>Acacia auriculiformis</i>	39		50	60x45	30%	\$0.00	\$0.00	\$0.00	Power line utility on the north side of canopy, previous co-dominant first order branch failed leaving a cavity in trunk, invasive species
23	Acacia	<i>Acacia auriculiformis</i>	9		25	30x30	40%	\$0.00	\$0.00	\$0.00	Co-dom with inclusion, invasive species
24	Acacia	<i>Acacia auriculiformis</i>	22.5		45	60x60	50%	\$0.00	\$0.00	\$0.00	Co-dom with inclusion, decay in first and second order branches, invasive species
25	Sabal palm	<i>Sabal palmetto</i>		13		16x16	60%	\$32.99	\$428.87	\$257.32	Sub-canopy
26	Acacia	<i>Acacia auriculiformis</i>	11.5		30	30x22	30%	\$0.00	\$0.00	\$0.00	Co-canopy, multi stemmed, invasive species
27	Acacia	<i>Acacia auriculiformis</i>	12		30	30x22	30%	\$0.00	\$0.00	\$0.00	Co-canopy, multi stemmed, decay in trunk, invasive species
28	Sabal palm	<i>Sabal palmetto</i>		15		18x18	70%	\$32.99	\$494.85	\$346.40	
29	Sabal palm	<i>Sabal palmetto</i>		17		18x18	70%	\$32.99	\$560.83	\$392.58	
30	Acacia	<i>Acacia auriculiformis</i>	6		26	28x22	30%	\$0.00	\$0.00	\$0.00	Co-canopy, co-dom with inclusion, invasive species
31	Acacia	<i>Acacia auriculiformis</i>	16		45	45x30	30%	\$0.00	\$0.00	\$0.00	Co-canopy, co-dom with inclusion, invasive species
32	Sabal palm	<i>Sabal palmetto</i>		12		16x16	70%	\$32.99	\$395.88	\$277.12	Co-canopy
33	Sabal palm	<i>Sabal palmetto</i>		10		16x16	70%	\$32.99	\$329.90	\$230.93	Co-canopy
34	Sabal palm	<i>Sabal palmetto</i>		10		16x16	70%	\$32.99	\$329.90	\$230.93	Co-canopy
35	Sabal palm	<i>Sabal palmetto</i>		10		16x16	70%	\$32.99	\$329.90	\$230.93	Co-canopy
36	Live oak	<i>Quercus virginiana</i>	10			30x26	50%	\$354.17	\$3,541.70	\$1,770.85	Co-canopy, planted under power line utility, multi co-dom
37	Acacia	<i>Acacia auriculiformis</i>	7		27	26x18	45%	\$0.00	\$0.00	\$0.00	Co-canopy, invasive species
38	Sabal palm	<i>Sabal palmetto</i>		8		16x16	70%	\$32.99	\$263.92	\$184.74	Co-canopy
39	Acacia	<i>Acacia auriculiformis</i>	11.5		30	26x16	40%	\$0.00	\$0.00	\$0.00	Co-canopy, planted under power line utility, multi co-dom, invasive species
40	Sabal palm	<i>Sabal palmetto</i>		8		16x16	70%	\$32.99	\$263.92	\$184.74	Co-canopy

Tree #	Common name	Botanical name	DBH	Height CT	Height OA	Canopy square ft	Condition	Price per in / ft	Value before Diminution	Value	Notes
41	Acacia	<i>Acacia auriculiformis</i>	6		27	26x18	45%	\$0.00	\$0.00	\$0.00	Co-canopy, multi stemmed, invasive species
42	Sabal palm	<i>Sabal palmetto</i>		13		16x16	70%	\$32.99	\$428.87	\$300.21	Interfering with power line utility
43	Acacia	<i>Acacia auriculiformis</i>	8		26	26x16	40%	\$0.00	\$0.00	\$0.00	Co-canopy, planted under power line utility, multi co-dom, invasive species
44	Acacia	<i>Acacia auriculiformis</i>	6		30	30x26	40%	\$0.00	\$0.00	\$0.00	Co-canopy, planted under power line utility, multi co-dom, invasive species
45	Acacia	<i>Acacia auriculiformis</i>	12		35	40x32	40%	\$0.00	\$0.00	\$0.00	Co-canopy, planted under power line utility, multi co-dom, invasive species
46	Sabal palm	<i>Sabal palmetto</i>		11		16x16	60%	\$32.99	\$362.89	\$217.73	Co-canopy
47	Sabal palm	<i>Sabal palmetto</i>		4		12x12	60%	\$32.99	\$131.96	\$79.18	Co-canopy
48	Acacia	<i>Acacia auriculiformis</i>	21		35	40x32	40%	\$0.00	\$0.00	\$0.00	Co-canopy, planted under power line utility, multi co-dom, multi stemmed group, invasive species
49	Acacia	<i>Acacia auriculiformis</i>	6.5		30	26x16	40%	\$0.00	\$0.00	\$0.00	Co-canopy, invasive species
50	Acacia	<i>Acacia auriculiformis</i>	5.5		30	26x16	40%	\$0.00	\$0.00	\$0.00	Co-canopy, invasive species
51	Bishop wood	<i>Bischofia javanica</i>	22		30	38x32	50%	\$0.00	\$0.00	\$0.00	Co-canopy, invasive species
52	Sabal palm	<i>Sabal palmetto</i>		15		16x16	70%	\$32.99	\$494.85	\$346.40	Interfering with power line utility
53	Live oak	<i>Quercus virginiana</i>	11		35	30x30	60%	\$354.17	\$3,895.87	\$2,337.52	Co-canopy, planted under power line utility, multi co-dom
54	Acacia	<i>Acacia auriculiformis</i>	11.5		35	40x32	40%	\$0.00	\$0.00	\$0.00	Co-canopy, planted under power line utility, multi co-dom, invasive species
55	Acacia	<i>Acacia auriculiformis</i>	10.5		35	40x32	40%	\$0.00	\$0.00	\$0.00	Co-canopy, invasive species
56	Live oak	<i>Quercus virginiana</i>	8.5		35	40x32	40%	\$354.17	\$3,010.45	\$1,204.18	Co-canopy, planted under power line utility
57	Sabal palm	<i>Sabal palmetto</i>		5		12x12	60%	\$32.99	\$164.95	\$98.97	Co-canopy
58	Live oak	<i>Quercus virginiana</i>	10.5		30	40x32	40%	\$354.17	\$3,718.79	\$1,487.51	Co-canopy, planted under power line utility
59	Carrot wood	<i>Cupaniopsis anacardioides</i>	26		30	40x40	50%	\$0.00	\$0.00	\$0.00	Mult stemmed, co-canopy, invasive species
60	Carrot wood	<i>Cupaniopsis anacardioides</i>	22.5		30	40x40	50%	\$0.00	\$0.00	\$0.00	Mult stemmed, co-canopy, invasive species
61	Carrot wood	<i>Cupaniopsis anacardioides</i>	24		30	40x40	50%	\$0.00	\$0.00	\$0.00	Mult stemmed, co-canopy, invasive species
62	Acacia	<i>Acacia auriculiformis</i>	11			40x32	40%	\$0.00	\$0.00	\$0.00	Co-canopy, planted under power line utility, co-dom with inclusion, invasive species
63	Acacia	<i>Acacia auriculiformis</i>	28			40x32	40%	\$0.00	\$0.00	\$0.00	Co-canopy, planted under power line utility, multi co-dom with inclusion, invasive species
64	Sabal palm	<i>Sabal palmetto</i>		4		18x18	70%	\$32.99	\$131.96	\$92.37	Co-canopy
65	Sabal palm	<i>Sabal palmetto</i>		4		18x18	70%	\$32.99	\$131.96	\$92.37	Co-canopy
66	Live oak	<i>Quercus virginiana</i>	4.5			20x16	60%	\$354.17	\$1,593.77	\$956.26	Co-canopy, planted under power line utility

PZ23-12000009

01/02/2025

DRC

PZ23-12000009

03/05/2025

Tree #	Common name	Botanical name	DBH	Height CT	Height OA	Canopy square ft	Condition	Price per in / ft	Value before Diminution	Value	Notes
											PZ23-12000009 01/02/2025
67	Live oak	<i>Quercus virginiana</i>	4.5			14x10	60%	\$354.17	\$1,593.77	\$956.26	Co-canopy, planted under power line utility
68	Live oak	<i>Quercus virginiana</i>	8.5			40x20	50%	\$354.17	\$3,010.45	\$1,505.22	Co-canopy, co-dom with inclusion, planted under power line utility
69	Live oak	<i>Quercus virginiana</i>	6.5			19x12	50%	\$354.17	\$2,302.11	\$1,151.05	Sub-canopy, planted under power line utility
70	Live oak	<i>Quercus virginiana</i>	15.5			48x38	50%	\$354.17	\$5,489.64	\$2,744.82	Co-canopy, multi co-dom, planted under power line utility
71	Sabal palm	<i>Sabal palmetto</i>		20		16x16	70%	\$32.99	\$659.80	\$461.86	
72	Sabal palm	<i>Sabal palmetto</i>		25		16x16	70%	\$32.99	\$824.75	\$577.33	
73	Gumbo limbo	<i>Bursera simaruba</i>	12.5		20	24x14	60%	\$312.50	\$3,906.25	\$2,343.75	Planted in center medium, restricted roots 2 side trunk is 7ft away from curb
74	Royal palm	<i>Roystonea regia</i>		25		20x20	70%	\$129.17	\$3,229.25	\$2,260.48	
75	Solitaire palm	<i>Ptychosperma elegans</i>		15		12x12	70%	\$30.00	\$450.00	\$315.00	
76	Royal palm	<i>Roystonea regia</i>		25		20x20	70%	\$129.17	\$3,229.25	\$2,260.48	
77	Royal palm	<i>Roystonea regia</i>		25		20x20	70%	\$129.17	\$3,229.25	\$2,260.48	
78	Solitaire palm	<i>Ptychosperma elegans</i>		20		12x12	70%	\$30.00	\$600.00	\$420.00	
79	Solitaire palm	<i>Ptychosperma elegans</i>		13		12x12	70%	\$30.00	\$390.00	\$273.00	
80	Solitaire palm	<i>Ptychosperma elegans</i>		13		12x12	70%	\$30.00	\$390.00	\$273.00	
81	Mahogany	<i>Swietenia mahagoni</i>	20		30	40x30	40%	\$312.50	\$6,250.00	\$2,500.00	DRC PZ23-12000009 03/05/2025
82	Mahogany	<i>Swietenia mahagoni</i>	26.5		30	40x30	50%	\$312.50	\$8,281.25	\$4,140.63	Planted in center medium, restricted roots 2 side trunk is 7ft away from curb, multi co-dom
83	Mahogany	<i>Swietenia mahagoni</i>	21.5		30	40x30	50%	\$312.50	\$6,718.75	\$3,359.38	Planted in center medium, restricted roots 2 side trunk is 7ft away from curb, multi co-dom
84	Sabal palm	<i>Sabal palmetto</i>		13		16x16	60%	\$32.99	\$428.87	\$257.32	Co-canopy
85	Sabal palm	<i>Sabal palmetto</i>		13		16x16	70%	\$32.99	\$428.87	\$300.21	
86	Sabal palm	<i>Sabal palmetto</i>		25		16x16	70%	\$32.99	\$824.75	\$577.33	
87	Sabal palm	<i>Sabal palmetto</i>		12		16x16	70%	\$32.99	\$395.88	\$277.12	
88	Mahogany	<i>Swietenia mahagoni</i>	17.5		30	40x30	45%	\$312.50	\$5,468.75	\$2,460.94	Planted in center medium, restricted roots 2 side trunk is 7ft away from curb, previous trunk damage, multi co-dom
89	Gumbo limbo	<i>Bursera simaruba</i>	14		20	24x14	60%	\$312.50	\$4,375.00	\$2,625.00	Planted in center medium, restricted roots 2 side trunk is 7ft away from curb, co-canopy
90	Mahogany	<i>Swietenia mahagoni</i>	20.5		35	50x35	45%	\$312.50	\$6,406.25	\$2,882.81	Planted in center medium, restricted roots 2 side trunk is 7ft away from curb, co-canopy, multi co-dom, broken second order branches from traffic



Tree #	Common name	Botanical name	DBH	Height CT	Height OA	Canopy square ft	Condition	Price per in / ft	Value before Diminution	Value	Notes
<b>PZ23-12000009</b> <b>01/02/2025</b>											
91	Mahogany	<i>Swietenia mahagoni</i>	25.5		35	50x35	50%	\$312.50	\$7,968.75	\$3,984.38	Planted in center medium, restricted roots 2 side trunk is 7ft away from curb, co-canopy, multi co-dom
92	Live oak	<i>Quercus virginiana</i>	15.5		25	26x22	60%	\$354.17	\$5,489.64	\$3,293.78	Planted in center medium, restricted roots 2 side trunk is 7ft away from curb, co-canopy, damage on lower trunk
93	Live oak	<i>Quercus virginiana</i>	7.5		23	26x22	60%	\$354.17	\$2,656.28	\$1,593.77	Planted in center medium, restricted roots 2 side trunk is 7ft away from curb, co-canopy, damage on lower trunk
94	Live oak	<i>Quercus virginiana</i>	7.5		23	23x20	70%	\$354.17	\$2,656.28	\$1,859.39	Planted in center medium, restricted roots 2 side trunk is 7ft away from curb
95	Live oak	<i>Quercus virginiana</i>	7		23	26x22	70%	\$354.17	\$2,479.19	\$1,735.43	Planted in center medium, restricted roots 2 side trunk is 7ft away from curb
96	Gumbo limbo	<i>Bursera simaruba</i>	16		25	36x30	50%	\$312.50	\$5,000.00	\$2,500.00	Planted in center medium, restricted roots 2 side trunk is 7ft away from curb, co-canopy, damage on lower trunk, multi co-dom
97	Live oak	<i>Quercus virginiana</i>	8.5		23	20x20	70%	\$354.17	\$3,010.45	\$2,107.31	Planted in center medium, restricted roots 2 side trunk is 7ft away from curb
98	Live oak	<i>Quercus virginiana</i>	11		23	26x23	60%	\$354.17	\$3,895.87	\$2,337.52	Planted in center medium, restricted roots 2 side trunk is 7ft away from curb
99	Live oak	<i>Quercus virginiana</i>	13		23	20x20	70%	\$354.17	\$4,604.21	\$3,222.95	Planted in center medium, restricted roots 2 side trunk is 7ft away from curb
<b>DRC</b> <b>PZ23-12000009</b> <b>03/05/2025</b>											
100	Solitaire palm	<i>Ptychosperma elegans</i>		12		12x12	70%	\$30.00	\$360.00	\$252.00	
101	Royal palm	<i>Roystonea regia</i>		25		20x20	70%	\$129.17	\$3,229.25	\$2,260.48	70%
102	Royal palm	<i>Roystonea regia</i>		26		20x20	70%	\$129.17	\$3,358.42	\$2,350.89	
103	Solitaire palm	<i>Ptychosperma elegans</i>		12		12x12	70%	\$30.00	\$360.00	\$252.00	
104	Live oak	<i>Quercus virginiana</i>	13		25	30x26	70%	\$354.17	\$4,604.21	\$3,222.95	Planted in center medium, restricted roots 2 side trunk is 7ft away from curb
105	Live oak	<i>Quercus virginiana</i>	11.5		25	28x26	70%	\$354.17	\$4,072.96	\$2,851.07	Planted in center medium, restricted roots 2 side trunk is 7ft away from curb
106	Live oak	<i>Quercus virginiana</i>	7.5		23	22x20	70%	\$354.17	\$2,656.28	\$1,859.39	Planted in center medium, restricted roots 2 side trunk is 7ft away from curb
107	Sabal palm	<i>Sabal palmetto</i>		12		16x16	70%	\$32.99	\$395.88	\$277.12	
108	Sabal palm	<i>Sabal palmetto</i>		22		16x16	70%	\$32.99	\$725.78	\$508.05	
109	Mahogany	<i>Swietenia mahagoni</i>	25		30	65x60	50%	\$312.50	\$7,812.50	\$3,906.25	Planted in center medium, restricted roots 2 side trunk is 7ft away from curb, previous trunk damage, multi co-dom
110	Sabal palm	<i>Sabal palmetto</i>		25		16x16	70%	\$32.99	\$824.75	\$577.33	
111	Sabal palm	<i>Sabal palmetto</i>		12		16x16	70%	\$32.99	\$395.88	\$277.12	

PZ23-12000009  
01/02/2025

Tree #	Common name	Botanical name	DBH	Height CT	Height OA	Canopy square ft	Condition	Price per in / ft	Value before Diminution	Value	Notes
112	Sabal palm	<i>Sabal palmetto</i>		10		16x16	70%	\$32.99	\$329.90	\$230.93	
113	Sabal palm	<i>Sabal palmetto</i>		10		16x16	70%	\$32.99	\$329.90	\$230.93	
114	Sabal palm	<i>Sabal palmetto</i>		12		16x16	70%	\$32.99	\$395.88	\$277.12	
115	Acacia	<i>Acacia auriculiformis</i>	28			40x32	40%	\$0.00	\$0.00	\$0.00	Co-canopy, planted under power line utility, multi co-dom with inclusion, invasive species
										\$116,678.68	

DRC

PZ23-12000009  
03/05/2025

PZ23-12000009  
01/02/2025



**DRC**

PZ23-12000009  
03/05/2025

1	Sabal palm	<i>Sabal palmetto</i>		17		16x16	70%	\$32.99	\$560.83	\$392.58	Trunk heavy with vine
---	------------	-----------------------	--	----	--	-------	-----	---------	----------	----------	-----------------------



PZ23-12000009  
01/02/2025



**DRC**

PZ23-12000009  
03/05/2025

2	Strangler fig	<i>Ficus aurea</i>	15		35	30x30	50%	\$314.58	\$4,718.70	\$2,359.35	Multi stemmed
---	---------------	--------------------	----	--	----	-------	-----	----------	------------	------------	---------------



PZ23-12000009  
01/02/2025



**DRC**

PZ23-12000009  
03/05/2025

3	Indian rose wood	<i>Dalbergia sissoo</i>	25.5			40x20	15%	\$172.17	\$4,390.34	\$658.55	Major tip decline major decay, dead wood, decay in first- order branches
---	---------------------	-----------------------------	------	--	--	-------	-----	----------	------------	----------	--



PZ23-12000009

01/02/2025



DRC

PZ23-12000009

03/05/2025

4	Sabal palm	<i>Sabal palmetto</i>		6		14x24	60%	\$32.99	\$197.94	\$118.76	Sub-canopy to rosewood tree
---	------------	-----------------------	--	---	--	-------	-----	---------	----------	----------	-----------------------------



PZ23-12000009  
01/02/2025



DRC

PZ23-12000009  
03/05/2025

5	Black olive	<i>Bucida buceras</i>	18			60x60	45%	\$358.33	\$6,449.94	\$2,902.47	Decay in first and second-order branches, previous trunk damage
---	-------------	-----------------------	----	--	--	-------	-----	----------	------------	------------	---

PZ23-12000009

01/02/2025



DRC

PZ23-12000009

03/05/2025

6	Java plum	<i>Syzygium cumini</i>	46.5			55x40	40%	\$0.00	\$0.00	\$0.00	Previous hatrack pruning, multi co-dom, poor structure, decay in first and second-order branches
---	-----------	------------------------	------	--	--	-------	-----	--------	--------	--------	--





DRC

PZ23-12000009

03/05/2025

7	Black olive	<i>Bucida buceras</i>	23			55x40	40%	\$358.33	\$8,241.59	\$3,296.64	Co-dom with inclusion, co-canopy, decay in first and second-order branches, sparse foliage
---	-------------	-----------------------	----	--	--	-------	-----	----------	------------	------------	--



PZ23-12000009  
01/02/2025



**DRC**

PZ23-12000009  
03/05/2025

8	Black olive	<i>Bucida buceras</i>	22			60x50	50%	\$358.33	\$7,883.26	\$3,941.63	Decay in first order, previous storm damage, poor structure
---	-------------	-----------------------	----	--	--	-------	-----	----------	------------	------------	---



PZ23-12000009

01/02/2025



DRC

PZ23-12000009

03/05/2025

9	Sabal palm	<i>Sabal palmetto</i>		9		12x12	70%	\$32.99	\$296.91	\$207.84	
---	------------	-----------------------	--	---	--	-------	-----	---------	----------	----------	--



PZ23-12000009

01/02/2025



DRC

PZ23-12000009

03/05/2025

10	Java plum	<i>Syzygium cumini</i>	35		17	20x20	60%	\$0.00	\$0.00	\$0.00	Multi-stemmed, invasive species
----	-----------	------------------------	----	--	----	-------	-----	--------	--------	--------	---------------------------------

PZ23-12000009  
01/02/2025



11	Sabal palm	<i>Sabal palmetto</i>		25		16x16	70%	\$32.99	\$824.75	\$577.33	PZ23-12000009 03/05/2025
----	------------	-----------------------	--	----	--	-------	-----	---------	----------	----------	-----------------------------



PZ23-12000009  
01/02/2025



12	Sabal palm	<i>Sabal palmetto</i>		4		16x16	70%	\$32.99	\$131.96	\$92.37	PZ23-12000009 03/05/2025
----	------------	-----------------------	--	---	--	-------	-----	---------	----------	---------	-----------------------------



PZ23-12000009

01/02/2025



13	Live oak	<i>Quercus virginiana</i>	22		20	40x30	70%	\$354.17	\$7,791.74	\$5,454.22	PZ23-12000009 03/05/2025 Cluster 7 trunks 22 DBH with all trunks
14	Acacia	<i>Acacia auriculiformis</i>	8.5		25	26x22	50%	\$0.00	\$0.00	\$0.00	Co-canopy, invasive species
15	Christmas palm DBL	<i>Adonidia merrillii</i>		13		12x12	70%	\$91.67	\$2,383.42	\$1,668.40	Two trunks
16	Christmas palm	<i>Adonidia merrillii</i>		13		12x12	70%	\$91.67	\$1,191.71	\$834.20	



PZ23-12000009  
01/02/2025



17	Live oak	<i>Quercus virginiana</i>	10.5		20	30x30	50%	\$354.17	\$3,718.79	\$1,859.39	PZ23-12000009 03/05/2025	Major sucker growth on trunk, co-dom, poor structure
----	----------	---------------------------	------	--	----	-------	-----	----------	------------	------------	-----------------------------	--



PZ23-12000009

01/02/2025



18	Live oak	<i>Quercus virginiana</i>	3.5		15	14x14	60%	\$354.17	\$1,239.60	\$743.76	PZ23-12000009 03/05/2025
----	----------	---------------------------	-----	--	----	-------	-----	----------	------------	----------	-----------------------------





DRC

PZ23-12000009

03/05/2025

19	Strangler fig	<i>Ficus aurea</i>	4.5		10	16x12	50%	\$314.58	\$1,415.61	\$707.81	Co-canopy
----	------------------	--------------------	-----	--	----	-------	-----	----------	------------	----------	-----------



PZ23-12000009

01/02/2025



DRC

PZ23-12000009

03/05/2025

20	Sabal palm	<i>Sabal palmetto</i>		17		16x16	70%	\$32.99	\$560.83	\$392.58	
----	------------	-----------------------	--	----	--	-------	-----	---------	----------	----------	--



PZ23-12000009

01/02/2025



DRC

PZ23-12000009

03/05/2025

Multi-stemmed, decay in first and second-order branches, invasive species

21	Schefflera	<i>Schefflera actinophylla</i>	36		25	40x40	50%	\$0.00	\$0.00	\$0.00	
----	------------	--------------------------------	----	--	----	-------	-----	--------	--------	--------	--



PZ23-12000009

01/02/2025



DRC

											PZ23-12000009 03/05/2025	Power line utility on the north side of canopy, previous co-dominant first order branch failed leaving a cavity in trunk, invasive species
22	Acacia	<i>Acacia auriculiformis</i>	39		50	60x45	30%	\$0.00	\$0.00	\$0.00		



PZ23-12000009

01/02/2025



DRC

PZ23-12000009

03/05/2025

Power line utility on the north side of canopy, previous co-dominant first order branch failed leaving a cavity in trunk, invasive species

22	Acacia	<i>Acacia auriculiformis</i>	39		50	60x45	30%	\$0.00	\$0.00	\$0.00	
----	--------	------------------------------	----	--	----	-------	-----	--------	--------	--------	--



PZ23-12000009

01/02/2025



DRC

23	Acacia	<i>Acacia auriculiformis</i>	9		25	30x30	40%	\$0.00	\$0.00	\$0.00	PZ23-12000009 with inclusion, invasive species 03/05/2025
----	--------	------------------------------	---	--	----	-------	-----	--------	--------	--------	--

PZ23-12000009

01/02/2025



DRC

PZ23-12000009

03/05/2025

Condition with inclusion, decay  
in first and second order  
branches, invasive species

24	Acacia	<i>Acacia auriculiformis</i>	22.5		45	60x60	50%	\$0.00	\$0.00	\$0.00	
----	--------	------------------------------	------	--	----	-------	-----	--------	--------	--------	--



PZ23-12000009  
01/02/2025



DRC

25	Sabal palm	<i>Sabal palmetto</i>		13		16x16	60%	\$32.99	\$428.87	\$257.32	PZ23-12000009 03/05/2025	Sub-canopy
----	------------	-----------------------	--	----	--	-------	-----	---------	----------	----------	-----------------------------	------------



PZ23-12000009  
01/02/2025



DRC

PZ23-12000009  
03/05/2025  
Coconut palm, multi stemmed,  
invasive species

26	Acacia	<i>Acacia auriculiformis</i>	11.5		30	30x22	30%	\$0.00	\$0.00	\$0.00	
----	--------	------------------------------	------	--	----	-------	-----	--------	--------	--------	--



PZ23-12000009

01/02/2025



DRC

PZ23-12000009

03/05/2025

Coconut palm, multi stemmed,  
decay in trunk, invasive  
species

27	Acacia	<i>Acacia auriculiformis</i>	12		30	30x22	30%	\$0.00	\$0.00	\$0.00	
----	--------	------------------------------	----	--	----	-------	-----	--------	--------	--------	--



PZ23-12000009

01/02/2025



DRC

28	Sabal palm	<i>Sabal palmetto</i>		15		18x18	70%	\$32.99	\$494.85	\$346.40	PZ23-12000009
											03/05/2025



PZ23-12000009

01/02/2025



29	Sabal palm	<i>Sabal palmetto</i>		17		18x18	70%	\$32.99	\$560.83	\$392.58	PZ23-12000009
											03/05/2025



PZ23-12000009

01/02/2025



DRC

PZ23-12000009

03/05/2025

30	Acacia	<i>Acacia auriculiformis</i>	6		26	28x22	30%	\$0.00	\$0.00	\$0.00	Co-canopy, co-dom with inclusion, invasive species
----	--------	------------------------------	---	--	----	-------	-----	--------	--------	--------	--



PZ23-12000009

01/02/2025



DRC

PZ23-12000009

03/05/2025

31	Acacia	<i>Acacia auriculiformis</i>	16		45	45x30	30%	\$0.00	\$0.00	\$0.00	Co-canopy, co-dom with inclusion, invasive species
----	--------	------------------------------	----	--	----	-------	-----	--------	--------	--------	--



PZ23-12000009

01/02/2025



32	Sabal palm	<i>Sabal palmetto</i>		12		16x16	70%	\$32.99	\$395.88	\$277.12	PZ23-12000009 03/05/2025	Co-canopy
----	------------	-----------------------	--	----	--	-------	-----	---------	----------	----------	-----------------------------	-----------





PZ23-12000009  
01/02/2025

DRC

33	Sabal palm	<i>Sabal palmetto</i>		10		16x16	70%	\$32.99	\$329.90	\$230.93	PZ23-12000009 03/05/2025 Co-canopy
----	------------	-----------------------	--	----	--	-------	-----	---------	----------	----------	--



PZ23-12000009  
01/02/2025



34	Sabal palm	<i>Sabal palmetto</i>		10		16x16	70%	\$32.99	\$329.90	\$230.93	PZ23-12000009 03/05/2025	Co-canopy
----	------------	-----------------------	--	----	--	-------	-----	---------	----------	----------	-----------------------------	-----------





35	Sabal palm	<i>Sabal palmetto</i>		10		16x16	70%	\$32.99	\$329.90	\$230.93	<div> <div>PZ23-12000009</div> <div>03/05/2025</div> </div> <div>Co-canopy</div>
----	------------	-----------------------	--	----	--	-------	-----	---------	----------	----------	--



PZ23-12000009

01/02/2025



DRC

36	Live oak	<i>Quercus virginiana</i>	10		25	30x26	50%	\$354.17	\$3,541.70	\$1,770.85	PZ23-12000009, planted under power line utility, multi co-dom 03/05/2025
----	----------	---------------------------	----	--	----	-------	-----	----------	------------	------------	---



PZ23-12000009  
01/02/2025



DRC

PZ23-12000009  
Co-canopy, invasive species  
03/05/2025

37	Acacia	<i>Acacia auriculiformis</i>	7		27	26x18	45%	\$0.00	\$0.00	\$0.00	
----	--------	------------------------------	---	--	----	-------	-----	--------	--------	--------	--





38	Sabal palm	<i>Sabal palmetto</i>		8		16x16	70%	\$32.99	\$263.92	\$184.74	<div> <div>PZ23-12000009</div> <div>03/05/2025</div> </div> <div>CC-canopy</div>
----	------------	-----------------------	--	---	--	-------	-----	---------	----------	----------	--



PZ23-12000009

01/02/2025



DRC

PZ23-12000009

03/05/2025

Co-canopy, planted under power line utility, multi co-canopy, invasive species

39	Acacia	<i>Acacia auriculiformis</i>	11.5		30	26x16	40%	\$0.00	\$0.00	\$0.00	Co-canopy, planted under power line utility, multi co-canopy, invasive species
40	Sabal palm	<i>Sabal palmetto</i>		8		16x16	70%	\$32.99	\$263.92	\$184.74	Co-canopy
41	Acacia	<i>Acacia auriculiformis</i>	6		27	26x18	45%	\$0.00	\$0.00	\$0.00	Co-canopy, multi stemmed, invasive species
42	Sabal palm	<i>Sabal palmetto</i>		13		16x16	70%	\$32.99	\$428.87	\$300.21	Interfering with power line utility





DRC

PZ23-12000009

03/05/2025

Co-canopy, planted under power line utility, multi co-dom, invasive species

Co-canopy, planted under power line utility, multi co-dom, invasive species

Co-canopy, planted under power line utility, multi co-dom, invasive species

43	Acacia	<i>Acacia auriculiformis</i>	8		26	26x16	40%	\$0.00	\$0.00	\$0.00	Co-canopy, planted under power line utility, multi co-dom, invasive species
44	Acacia	<i>Acacia auriculiformis</i>	6		30	30x26	40%	\$0.00	\$0.00	\$0.00	Co-canopy, planted under power line utility, multi co-dom, invasive species
45	Acacia	<i>Acacia auriculiformis</i>	12		35	40x32	40%	\$0.00	\$0.00	\$0.00	Co-canopy, planted under power line utility, multi co-dom, invasive species





DRC

PZ23-12000009

03/05/2025

46	Sabal palm	<i>Sabal palmetto</i>		11		16x16	60%	\$32.99	\$362.89	\$217.73	Co-canopy
47	Sabal palm	<i>Sabal palmetto</i>		4		12x12	60%	\$32.99	\$131.96	\$79.18	Co-canopy





DRC

PZ23-12000009

03/05/2025

48	Acacia	<i>Acacia auriculiformis</i>	21		35	40x32	40%	\$0.00	\$0.00	\$0.00	Co-canopy, planted under power line utility, multi co-dom, multi stemmed group, invasive species
49	Acacia	<i>Acacia auriculiformis</i>	6.5		30	26x16	40%	\$0.00	\$0.00	\$0.00	Co-canopy, invasive species
50	Acacia	<i>Acacia auriculiformis</i>	5.5		30	26x16	40%	\$0.00	\$0.00	\$0.00	Co-canopy, invasive species



PZ23-12000009  
01/02/2025



DRC

51	Bishop wood	<i>Bischofia javanica</i>	22		30	38x32	50%	\$0.00	\$0.00	\$0.00	PZ23-12000009 03/05/2025	Co-canopy, invasive species
----	-------------	---------------------------	----	--	----	-------	-----	--------	--------	--------	-----------------------------	-----------------------------





DRC

PZ23-12000009

03/05/2025

52	Sabal palm	<i>Sabal palmetto</i>		15		16x16	70%	\$32.99	\$494.85	\$346.40	Interfering with power line utility
----	------------	-----------------------	--	----	--	-------	-----	---------	----------	----------	-------------------------------------



PZ23-12000009

01/02/2025



DRC

PZ23-12000009

Co-owner, planted under power line utility, multi co-dom

03/05/2025

53	Live oak	<i>Quercus virginiana</i>	11		35	30x30	60%	\$354.17	\$3,895.87	\$2,337.52	
----	----------	---------------------------	----	--	----	-------	-----	----------	------------	------------	--



PZ23-12000009

01/02/2025



DRC

PZ23-12000009

03/05/2025

Coconut, planted under power line utility, multi-colored, invasive species

54	Acacia	<i>Acacia auriculiformis</i>	11.5		35	40x32	40%	\$0.00	\$0.00	\$0.00	
----	--------	------------------------------	------	--	----	-------	-----	--------	--------	--------	--





DRC

PZ23-12000009

03/05/2025

55	Acacia	<i>Acacia auriculiformis</i>	10.5		35	40x32	40%	\$0.00	\$0.00	\$0.00	Co-canopy, invasive species
----	--------	------------------------------	------	--	----	-------	-----	--------	--------	--------	-----------------------------



PZ23-12000009

01/02/2025



DRC

PZ23-12000009

03/05/2025

56	Live oak	<i>Quercus virginiana</i>	8.5		35	40x32	40%	\$354.17	\$3,010.45	\$1,204.18	Canopy, planted under power line utility
----	----------	---------------------------	-----	--	----	-------	-----	----------	------------	------------	--



PZ23-12000009  
01/02/2025



**DRC**

PZ23-12000009  
03/05/2025

57	Sabal palm	<i>Sabal palmetto</i>		5		12x12	60%	\$32.99	\$164.95	\$98.97	Co-canopy
----	------------	-----------------------	--	---	--	-------	-----	---------	----------	---------	-----------



PZ23-12000009

01/02/2025



DRC

58	Live oak	Quercus virginiana	10.5		30	40x32	40%	\$354.17	\$3,718.79	\$1,487.51	PZ23-12000009, planted under power line utility
03/05/2025											



PZ23-12000009  
01/02/2025



59	Carrot wood	<i>Cupaniopsis anacardioides</i>	26		30	40x40	50%	\$0.00	\$0.00	\$0.00	PZ23-12000009 03/05/2025	Multitrunked, co-canopy, invasive species
----	-------------	----------------------------------	----	--	----	-------	-----	--------	--------	--------	-----------------------------	---



PZ23-12000009  
01/02/2025



DRC

60	Carrot wood	<i>Cupaniopsis anacardioides</i>	22.5		30	40x40	50%	\$0.00	\$0.00	\$0.00	PZ23-12000009 03/05/2025	med, co-canopy, invasive species
----	-------------	----------------------------------	------	--	----	-------	-----	--------	--------	--------	-----------------------------	----------------------------------



PZ23-12000009

01/02/2025



DRC

61	Carrot wood	<i>Cupaniopsis anacardioides</i>	24		30	40x40	50%	\$0.00	\$0.00	\$0.00	PZ23-12000009 03/05/2025	Shaded, co-canopy, invasive species
----	-------------	----------------------------------	----	--	----	-------	-----	--------	--------	--------	-----------------------------	-------------------------------------





DRC

PZ23-12000009

03/05/2025

Co-canopy, planted under power line utility, co-dom with inclusion, invasive species

Co-canopy, planted under power line utility, multi co-dom with inclusion, invasive species

Co-canopy

Co-canopy

Co-canopy, planted under power line utility

Co-canopy, planted under power line utility

Co-canopy, co-dom with inclusion, planted under power line utility

Sub-canopy, planted under power line utility

Co-canopy, multi co-dom, planted under power line utility

62	Acacia	<i>Acacia auriculiformis</i>	11		30	40x32	40%	\$0.00	\$0.00	\$0.00	Co-canopy, planted under power line utility, co-dom with inclusion, invasive species
63	Acacia	<i>Acacia auriculiformis</i>	28		30	40x32	40%	\$0.00	\$0.00	\$0.00	Co-canopy, planted under power line utility, multi co-dom with inclusion, invasive species
64	Sabal palm	<i>Sabal palmetto</i>		4		18x18	70%	\$32.99	\$131.96	\$92.37	Co-canopy
65	Sabal palm	<i>Sabal palmetto</i>		4		18x18	70%	\$32.99	\$131.96	\$92.37	Co-canopy
66	Live oak	<i>Quercus virginiana</i>	4.5		20	20x16	60%	\$354.17	\$1,593.77	\$956.26	Co-canopy, planted under power line utility
67	Live oak	<i>Quercus virginiana</i>	4.5		20	14x10	60%	\$354.17	\$1,593.77	\$956.26	Co-canopy, planted under power line utility
68	Live oak	<i>Quercus virginiana</i>	8.5		20	40x20	50%	\$354.17	\$3,010.45	\$1,505.22	Co-canopy, co-dom with inclusion, planted under power line utility
69	Live oak	<i>Quercus virginiana</i>	6.5		20	19x12	50%	\$354.17	\$2,302.11	\$1,151.05	Sub-canopy, planted under power line utility
70	Live oak	<i>Quercus virginiana</i>	15.5		25	48x38	50%	\$354.17	\$5,489.64	\$2,744.82	Co-canopy, multi co-dom, planted under power line utility



PZ23-12000009  
01/02/2025



71	Sabal palm	<i>Sabal palmetto</i>		20		16x16	70%	\$32.99	\$659.80	\$461.86	PZ23-12000009 03/05/2025
----	------------	-----------------------	--	----	--	-------	-----	---------	----------	----------	-----------------------------



PZ23-12000009  
01/02/2025



DRC

72	Sabal palm	<i>Sabal palmetto</i>		25		16x16	70%	\$32.99	\$824.75	\$577.33	PZ23-12000009 03/05/2025
----	------------	-----------------------	--	----	--	-------	-----	---------	----------	----------	-----------------------------



PZ23-12000009  
01/02/2025

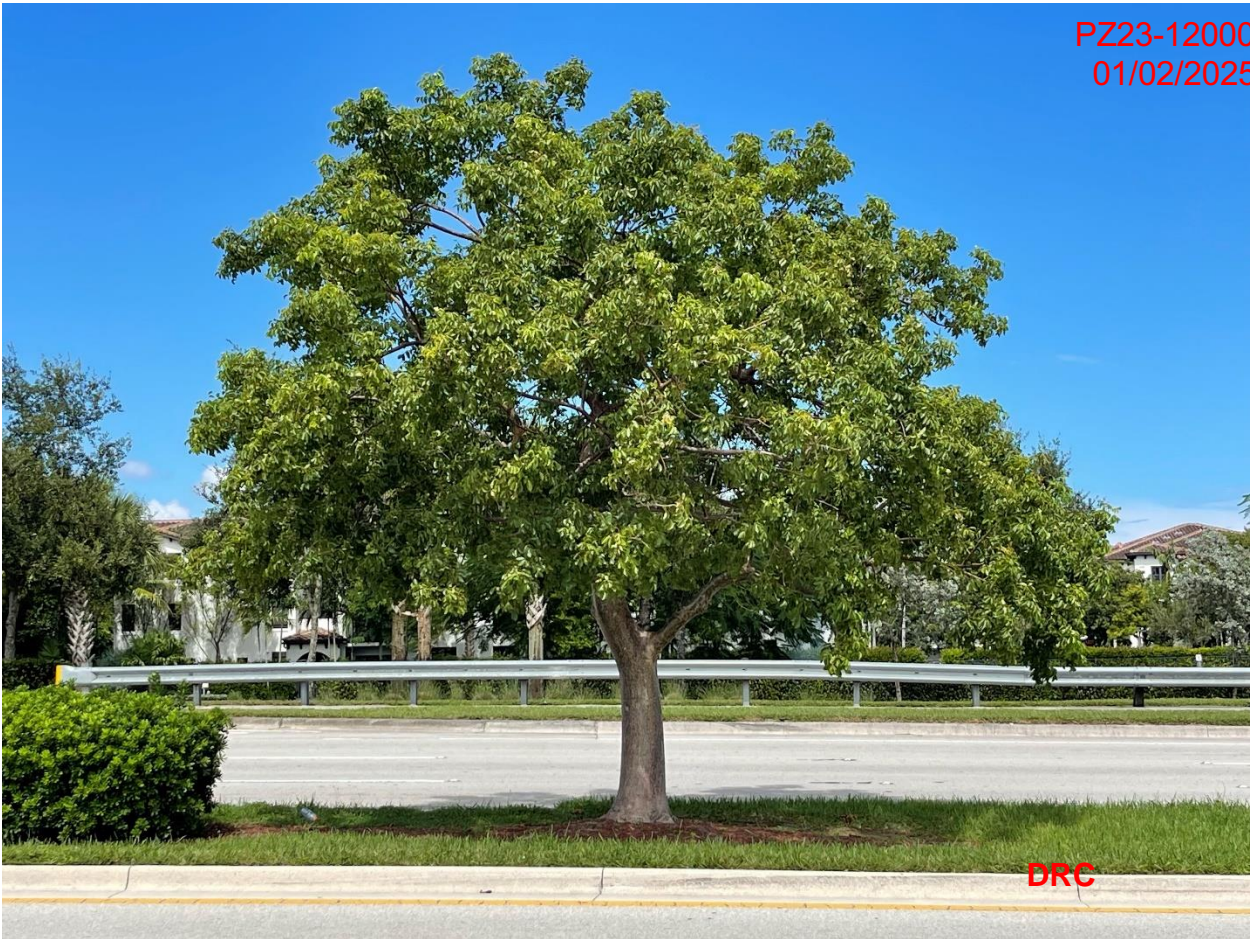

											PZ23-12000009	Planted in center medium, restricted roots 2 side trunk is 7 ft away from curb
73	Gumbo limbo	Bursera simaruba	12.5		20	24x14	60%	\$312.50	\$3,906.25	\$2,343.75	03/05/2025	





DRC

74	Royal palm	<i>Roystonea regia</i>		25		20x20	70%	\$129.17	\$3,229.25	\$2,260.48	PZ23-12000009 03/05/2025
75	Solitaire palm	<i>Ptychosperma elegans</i>		15		12x12	70%	\$30.00	\$450.00	\$315.00	
76	Royal palm	<i>Roystonea regia</i>		25		20x20	70%	\$129.17	\$3,229.25	\$2,260.48	
77	Royal palm	<i>Roystonea regia</i>		25		20x20	70%	\$129.17	\$3,229.25	\$2,260.48	



PZ23-12000009

01/02/2025



DRC

78	Solitaire palm	<i>Ptychosperma elegans</i>		20		12x12	70%	\$30.00	\$600.00	\$420.00	PZ23-12000009
79	Solitaire palm	<i>Ptychosperma elegans</i>		13		12x12	70%	\$30.00	\$390.00	\$273.00	03/05/2025
80	Solitaire palm	<i>Ptychosperma elegans</i>		13		12x12	70%	\$30.00	\$390.00	\$273.00	



PZ23-12000009

01/02/2025



DRC

PZ23-12000009  
03/05/2025  
Planted in center medium,  
restricted roots 2 side trunk is  
7ft away from curb, previous  
trunk damage, multi co-dom

81	Mahogany	<i>Swietenia mahagoni</i>	20		30	40x30	40%	\$312.50	\$6,250.00	\$2,500.00	
----	----------	---------------------------	----	--	----	-------	-----	----------	------------	------------	--



PZ23-12000009

01/02/2025



DRC

PZ23-12000009

03/05/2025

Planted in center medium, restricted roots 2 side trunk is 7ft away from curb, co-canopy, multi co-dom

82	Mahogany	<i>Swietenia mahagoni</i>	26.5		30	40x30	50%	\$312.50	\$8,281.25	\$4,140.63	
----	----------	---------------------------	------	--	----	-------	-----	----------	------------	------------	--



PZ23-12000009

01/02/2025



DRC

PZ23-12000009

03/05/2025

Planted in center medium, restricted roots 2 side trunk is 7ft away from curb, multi codom

83	Mahogany	<i>Swietenia mahagoni</i>	21.5		30	40x30	50%	\$312.50	\$6,718.75	\$3,359.38	
----	----------	---------------------------	------	--	----	-------	-----	----------	------------	------------	--



PZ23-12000009

01/02/2025



DRC

										PZ23-12000009	
84	Sabal palm	<i>Sabal palmetto</i>		13		16x16	60%	\$32.99	\$428.87	\$257.32	Co-canopy
85	Sabal palm	<i>Sabal palmetto</i>		13		16x16	70%	\$32.99	\$428.87	\$300.21	03/05/2025
86	Sabal palm	<i>Sabal palmetto</i>		25		16x16	70%	\$32.99	\$824.75	\$577.33	





DRC

87	Sabal palm	<i>Sabal palmetto</i>		12		16x16	70%	\$32.99	\$395.88	\$277.12	PZ23-12000009 03/05/2025
88	Mahogany	<i>Swietenia mahagoni</i>	17.5		30	40x30	45%	\$312.50	\$5,468.75	\$2,460.94	Planted in center medium, restricted roots 2 side trunk is 7ft away from curb, previous trunk damage, multi co-dom



PZ23-12000009

01/02/2025



89	Gumbo limbo	<i>Bursera simaruba</i>	14		20	24x14	60%	\$312.50	\$4,375.00	\$2,625.00	<div>PZ23-12000009</div> <div>03/05/2025</div> <div>center medium, restricted roots 2 side trunk is 7ft away from curb, co-canopy</div>
----	-------------	-------------------------	----	--	----	-------	-----	----------	------------	------------	---



PZ23-12000009

01/02/2025



DRC

PZ23-12000009

03/05/2025

Planted in center medium, restricted roots 2 side trunk is 7ft away from curb, co-canopy, multi co-dom, broken second order branches from traffic

90	Mahogany	<i>Swietenia mahagoni</i>	20.5		35	50x35	45%	\$312.50	\$6,406.25	\$2,882.81	
----	----------	---------------------------	------	--	----	-------	-----	----------	------------	------------	--



01/02/2025



03/05/2025

- 200009 in center medium,  
restricted roots 2 side trunk is  
7 ft away from curb, co-  
canopy, multi co-dom



PZ23-12000009

01/02/2025



DRC

PZ23-12000009

03/05/2025

Planted in center medium, restricted roots 2 side trunk is 7ft away from curb, co-canopy, damage on lower trunk

92	Live oak	<i>Quercus virginiana</i>	15.5		25	26x22	60%	\$354.17	\$5,489.64	\$3,293.78	
----	----------	---------------------------	------	--	----	-------	-----	----------	------------	------------	--



PZ23-12000009

01/02/2025



DRC

93	Live oak	<i>Quercus virginiana</i>	7.5		23	26x22	60%	\$354.17	\$2,656.28	\$1,593.77	Planted in center medium, restricted roots 2 side trunk is 7 ft away from curb, co-canopy, damage on lower trunk
----	----------	---------------------------	-----	--	----	-------	-----	----------	------------	------------	--

PZ23-12000009

03/05/2025





DRC

94	Live oak	<i>Quercus virginiana</i>	7.5		23	23x20	70%	\$354.17	\$2,656.28	\$1,859.39	<del>PZ23-12000009</del> PZ23-12000009 03/05/2025	center medium, restricted roots 2 side trunk is 7 ft away from curb
----	----------	---------------------------	-----	--	----	-------	-----	----------	------------	------------	---	---





DRC

95	Live oak	<i>Quercus virginiana</i>	7		23	26x22	70%	\$354.17	\$2,479.19	\$1,735.43	PZ23-12000009 03/05/2025	Planted in center medium, restricted roots 2 side trunk is 7' away from curb
----	----------	---------------------------	---	--	----	-------	-----	----------	------------	------------	-----------------------------	--



PZ23-12000009

01/02/2025



DRC

PZ23-12000009

03/05/2025

Planted in center medium, restricted roots 2 side trunk is 7ft away from curb, co-canopy, damage on lower trunk , multi co-dom

96	Gumbo limbo	Bursera simaruba	16		25	36x30	50%	\$312.50	\$5,000.00	\$2,500.00	
----	-------------	------------------	----	--	----	-------	-----	----------	------------	------------	--



PZ23-12000009

01/02/2025



DRC

											PZ23-12000009	center medium, restricted roots 2 side trunk is 7 ft away from curb
97	Live oak	<i>Quercus virginiana</i>	8.5		23	20x20	70%	\$354.17	\$3,010.45	\$2,107.31	03/05/2025	



PZ23-12000009

01/02/2025



DRC

98	Live oak	<i>Quercus virginiana</i>	11		23	26x23	60%	\$354.17	\$3,895.87	\$2,337.52	PZ23-12000009 03/05/2025 Planted in center medium, restricted roots 2 side trunk is 7' away from curb
----	----------	---------------------------	----	--	----	-------	-----	----------	------------	------------	---



PZ23-12000009  
01/02/2025



											PZ23-12000009	Planted in center medium, restricted roots 2 side trunk is 5 ft away from curb
99	Live oak	<i>Quercus virginiana</i>	13		23	20x20	70%	\$354.17	\$4,604.21	\$3,222.95	03/05/2025	





100	Solitaire palm	<i>Ptychosperma elegans</i>		12		12x12	70%	\$30.00	\$360.00	\$252.00	PZ23-12000009 03/05/2025
101	Royal palm	<i>Roystonea regia</i>		25		20x20	70%	\$129.17	\$3,229.25	\$2,260.48	
102	Royal palm	<i>Roystonea regia</i>		26		20x20	70%	\$129.17	\$3,358.42	\$2,350.89	
103	Solitaire palm	<i>Ptychosperma elegans</i>		12		12x12	70%	\$30.00	\$360.00	\$252.00	



PZ23-12000009

01/02/2025



DRC

104	Live oak	<i>Quercus virginiana</i>	13	25	30x26	70%	\$354.17	\$4,604.21	\$3,222.95	PZ23-12000009 03/05/2025 Planted in center medium, restricted roots 2 side trunk is 4' away from curb
-----	----------	---------------------------	----	----	-------	-----	----------	------------	------------	---



PZ23-12000009

01/02/2025



DRC

105	Live oak	<i>Quercus virginiana</i>	11.5		25	28x26	70%	\$354.17	\$4,072.96	\$2,851.07	PZ23-12000009 03/05/2025	Planted in center medium, restricted roots 2 side trunk is 5 ft away from curb
-----	----------	---------------------------	------	--	----	-------	-----	----------	------------	------------	-----------------------------	--





DRC

106	Live oak	<i>Quercus virginiana</i>	7.5		23	22x20	70%	\$354.17	\$2,656.28	\$1,859.39	PZ23-12000009 03/05/2025	Planted in center medium, restricted roots 2 side trunk is 7' away from curb
-----	----------	---------------------------	-----	--	----	-------	-----	----------	------------	------------	-----------------------------	--





107	Sabal palm	<i>Sabal palmetto</i>		12		16x16	70%	\$32.99	\$395.88	\$277.12	PZ23-12000009 03/05/2025
108	Sabal palm	<i>Sabal palmetto</i>		22		16x16	70%	\$32.99	\$725.78	\$508.05	



PZ23-12000009

01/02/2025



DRC

PZ23-12000009

03/05/2025

Planted in center medium, restricted roots 2 side trunk is 7ft away from curb, previous trunk damage, multi co-dom

109	Mahogany	<i>Swietenia mahagoni</i>	25		30	65x60	50%	\$312.50	\$7,812.50	\$3,906.25	
-----	----------	---------------------------	----	--	----	-------	-----	----------	------------	------------	--



PZ23-12000009

01/02/2025



DRC

PZ23-12000009

03/05/2025

110	Sabal palm	<i>Sabal palmetto</i>		25		16x16	70%	\$32.99	\$824.75	\$577.33	
111	Sabal palm	<i>Sabal palmetto</i>		12		16x16	70%	\$32.99	\$395.88	\$277.12	No photo
112	Sabal palm	<i>Sabal palmetto</i>		10		16x16	70%	\$32.99	\$329.90	\$230.93	No photo
113	Sabal palm	<i>Sabal palmetto</i>		10		16x16	70%	\$32.99	\$329.90	\$230.93	No photo
114	Sabal palm	<i>Sabal palmetto</i>		12		16x16	70%	\$32.99	\$395.88	\$277.12	No photo
115	Acacia	<i>Acacia auriculiformis</i>	28			40x32	40%	\$0.00	\$0.00	\$0.00	invasive species, No photo

Please feel free to contact me should you have any questions.

In Support

Trea Jones

Trea Jones/Sutton Consulting Arborist

ISA Certified Arborist #FL-9929A

TRAQ, Tree Risk Assessment Qualification

PPQ, Pruning Prescription Qualification

Sutton Consulting Arborist is staffed by professional Arborists, Horticulturists, and Landscape Inspectors. We utilize associates with expertise in their fields to provide the most accurate, efficient and useful information available to clients. We stand behind our work and can additionally answer any questions or fulfill needs for additional information or services.

P.O. Box 541237, Lake Worth, FL., 33454 (561) 493-3310

<http://suttonconsultingarborist.com> Email: [JSutton868@aol.com](mailto:JSutton868@aol.com)